

FCI CONFIDENTIAL

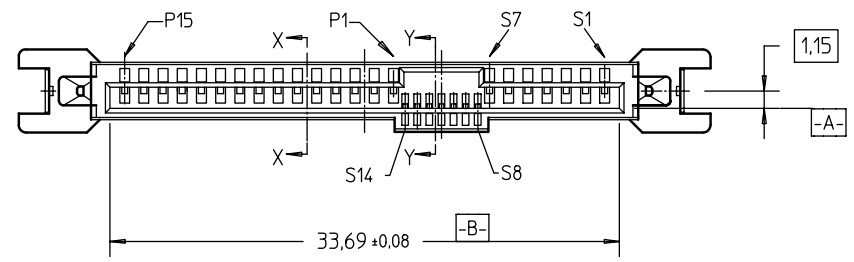

This document is the property of and embodies CONFIDENTIAL and PROPRIETARY information of FCI. No part of the information shown on this document may be used in any way or disclosed to others without the written consent of FCI. Copyright FCI.

PRODUCT NO	DIM L	RECOMMENDED P.C. BOARD THICKNESS	DIM M
10031077-003LF	2.70	1.57mm (0.062") / 2.36mm (0.093")	2.10



- NOTES:
- 5 THE STD PACKAGING IS IN TRAY.
 - 6 THE HOUSING WILL WITHSTAND EXPOSURE TO 260°C PEAK TEMPERATURE FOR 10 SECONDS IN A CONVECTION, INFRA-RED OR VAPOR PHASE REFLOW OVEN.
 - ⑦ THIS PRODUCT MEETS EUROPEAN UNION DIRECTIVES AND OTHER COUNTRY REGULATIONS AS DESCRIBED IN GS-22-008.
 - ⑧ PART NUMBERS ENDING IN "LF" MEANS FOR NOTE 7 LEAD FREE IDENTIFICATION. P/N XXXXXXXX-XXXLF IS EQUIVALENT TO PREVIOUS P/N XXXXXXXX-XXX.

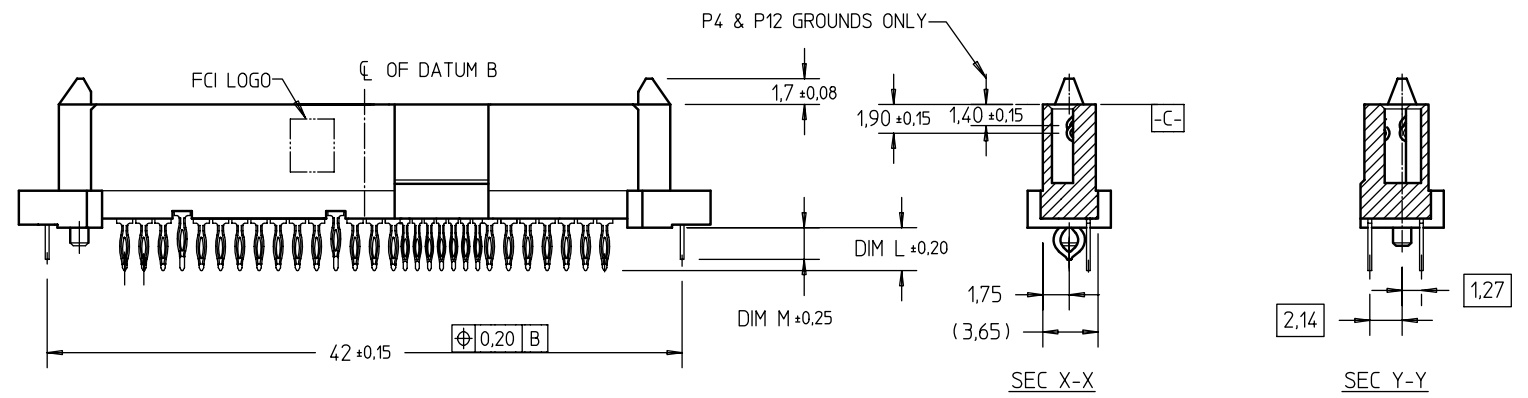
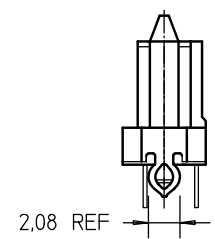

NOTES :
ALL OTHER DIMENSIONS, REFER TO SHEET 1.

mat'l. code		surface	tolerance	projection	product family
ISO 1302		ISO 406	ISO 1101		SAS
tr		tolerances unless otherwise specified			title
ecn no	dr	mm			SAS RECEPTACLE
date	angles	linear			VERTICAL PF TYPE ASSY
	± 2°	= ± 0.20			scale 2 : 1
	dr	GL L00	2004-09-23		dwg no
	enr	GL L00	2004-09-23		10031077
	chr	GL L00	2006-08-28		sheet 2 of 2
	appd	JOEY NG	2006-08-28		A4
sheet index	revision sheet				type
1					CUSTOMER Drawing